

Ø220	h8	0	220
		-0.072	219.928
Ø180	p6	+0.068	180.068
		+0.043	180.043
Ø160	m6	+0.04	160.04
		+0.015	160.015
40	P9	-0.026	39.974
		-0.066	39.912
4.15	H13	0	4.15
		0	4.15
Maß	Passung		

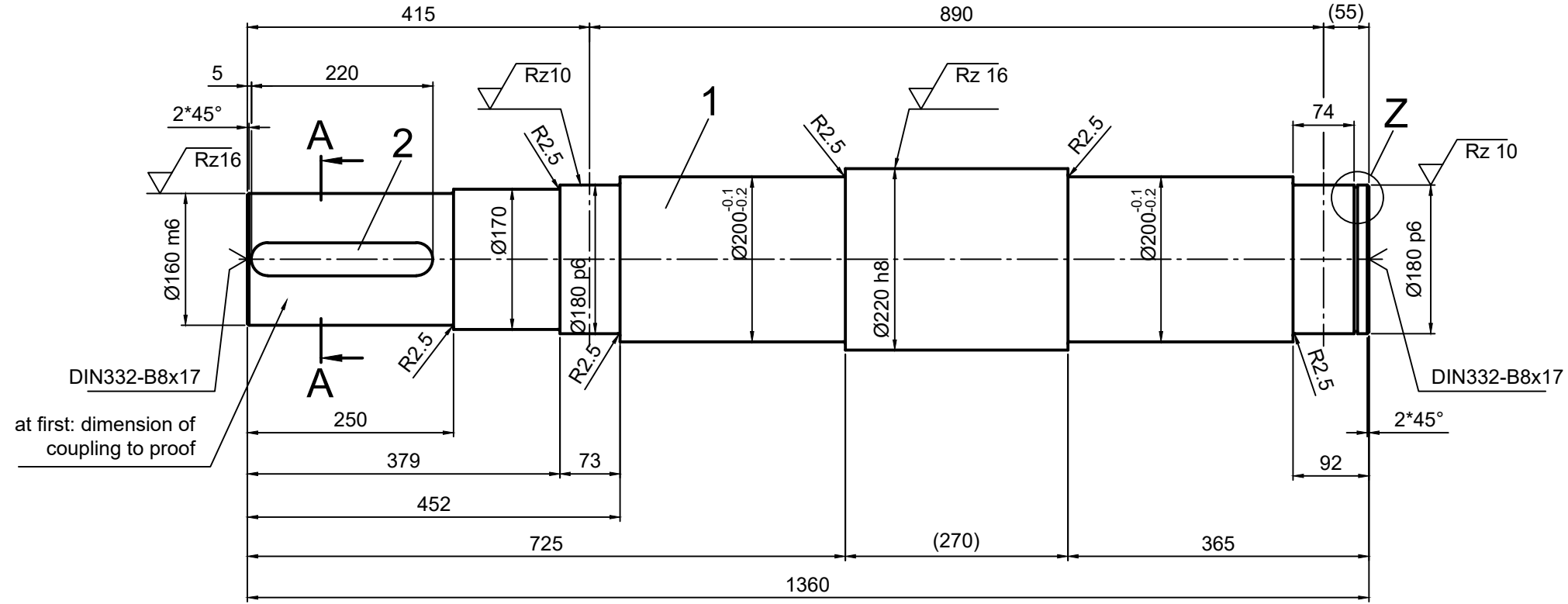

Prüfspezifikation 3.1B nach EN 10204
 ultraschall geprüft
 test certificate 3.1B to EN 10204
 ultrasonic-tested

Rz 40 (Rz 10 Rz 16 Rz 80)

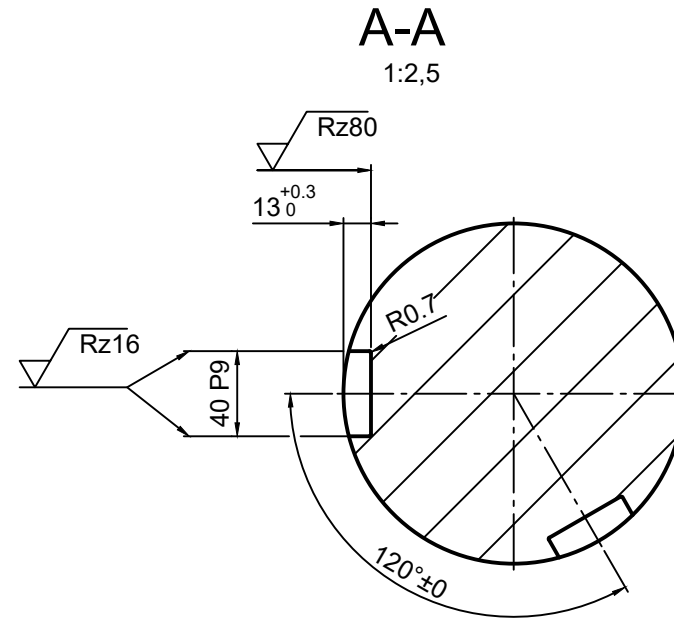
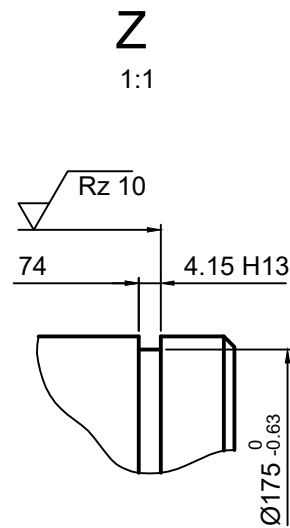

NOTLAR:
 1- REFERANS RESİM NO:Z13-33-008 E C SH 1/1 REV:1 "shaft for pinion"

2	FITTING KEY A40x22x220 DIN 6885	2	ST50-1K	3.0	-
1	SHAFT FOR PINION	1	C60	303.0	-
POZ	PARÇANIN ADI	ADET	MALZEME	AĞIRLIK	İLGİLİ RESİM NO
Pos	Part Name	Qty	Material	Weight	Description

TOPLAM/Total: 306.0 kg

Yapan	Tarih	Revizyon	No

<p>CETA MAKİNA SANAYİ VE TİCARET A.Ş. Tel: 90 212 861 44 44 info@ceta.com.tr</p>	<p>Soda Sanayii A.Ş. KROMSAN Krom Bileşikleri Fabrikası MERSİN</p>
<p>Dessau</p>	<p>SODYUM MONOKROMAT ÜNİTESİ 3.HAT DÖNER FIRIN PROJESİ 15-53/6 KISA FIRIN PİNYON MİLİ İM.DET.</p>

Proje	Tarih	İsim	İmza	Onay	Ölçek : 1/5	Resim No :	Pafta Formu	Reviz. No
Çizen	00.00.0000	---				KROM-15-35-4050	A2	0
Kontrol	00.00.0000	---						

ISO 128 BU RESİMİN BÜTÜN HAKLARI CETA'YA AİTTİR. YAZILI İZİN ALMADAN KULLANILAMAZ VE ÇOĞALTILAMAZ. All copyrights transformation or any other use of this document remain exclusive properties. TUM ÖLÇÜLER mm. All dimensions are mm.