

Bohrbild /Hole pattern

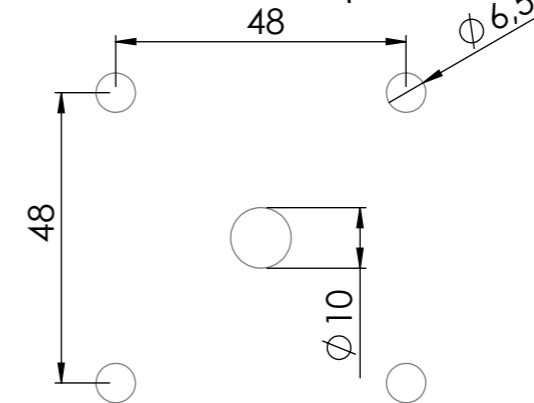

Schaltertype:
ULT125/3V/Z33S-D2/Z45/2xH11

Ue	690VAC
Ith	125A
AC23 (400V)	45kW
AC3 (400V)	37kW
Anschlussquerschnitt max / Connection cross	50mm ²
Drehmoment Klemmen / Torque clamps	2,5Nm-3Nm